

#2000 TRIGGER ASSEMBLY

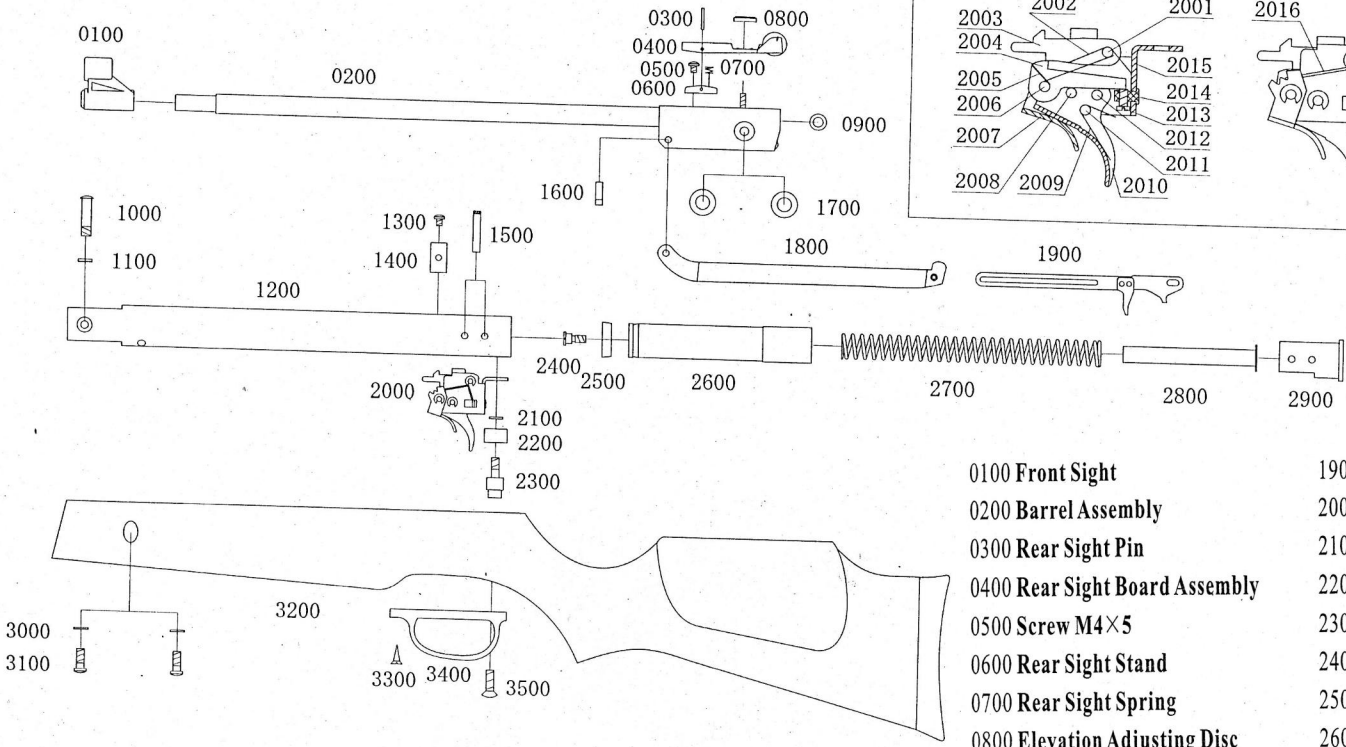
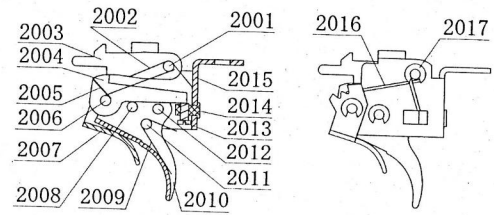

- | | | |
|--------------------------------|--------------------------|---------------------------|
| 0100 Front Sight | 1900 Push Bar | 2001 Lever Pin |
| 0200 Barrel Assembly | 2000 Trigger Assembly | 2002 Lever Spring |
| 0300 Rear Sight Pin | 2100 Washer | 2003 Lever |
| 0400 Rear Sight Board Assembly | 2200 Screw Guard Ring | 2004 Operating Arm |
| 0500 Screw M4×5 | 2300 Set Screw | 2005 Operating Arm Spring |
| 0600 Rear Sight Stand | 2400 Piston Screw | 2006 Operating Arm Pin |
| 0700 Rear Sight Spring | 2500 Piston Seal | 2007 Safety Button |
| 0800 Elevation Adjusting Disc | 2600 Piston Tube | 2008 Trigger Pin |
| 0900 O-ring 11×1.9 | 2700 Piston Spring | 2009 Trigger Spring |
| 1000 Connecting Screw | 2800 Lining Tube | 2010 Trigger |
| 1100 Connecting Screw Washer | 2900 End Block | 2011 Trigger Spring Pin |
| 1200 Receiver | 3000 Washer 5 (2) | 2012 Safety Pin |
| 1300 Screw M4×5 | 3100 Screw M5×12 (2) | 2013 Screw M3×8 |
| 1400 Scope Stop | 3200 Wooden Stock | 2014 Screw Nut |
| 1500 Pin (2) | 3300 Trigger Guard Screw | 2015 Trigger Block |
| 1600 Cocking Lever Pin | 3400 Trigger Guard | 2016 Safety Spring |
| 1700 Washer (2) | 3500 Screw M6 x 18 | 2017 Retaining Clip 3 (6) |
| 1800 Cocking Lever | | |

B23